

ITEM 12

S:\Project\2250\W\Project Plan\02-Design\02-Design.dwg: sheet 1 to sheet\2250-004 Two-way Traffic Operation Walton Lane (Shepperton).dwg

© Crown Copyright (License No. 100019816, Survey County Council 2011)

- Key:**
- Proposed two-way traffic operation
 - Existing one-way traffic operation

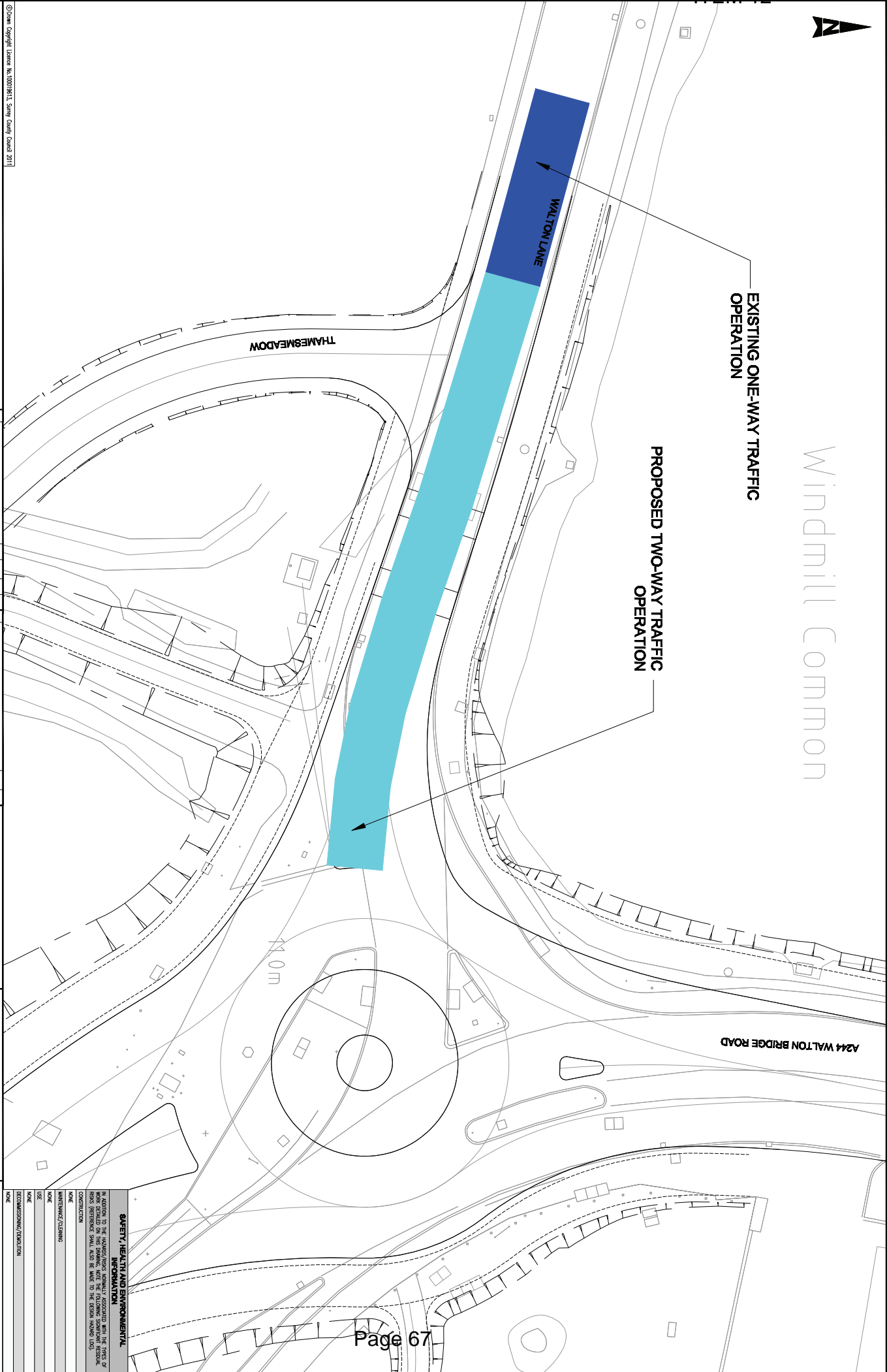

Rev	Description	By	Date	Check/Date	Rev	Reason of Issue	Date	Issue	
A	ISSUED FOR PRESENTATION	JHT	08/13	JHT	JHT	A	ISSUED FOR PRESENTATION	08/13	JHT

ATKINS
COSTAIN

Client
SURREY
A244 WALTON BRIDGE

The **WALTON LANE (SHEPPERTON) PROPOSED TWO-WAY WORKING**

Original Scale	1:125	Designed/Drawn/Checked	JHT	JHT	Authorised	JHT	
Scale	C	Date	28/09/13	Date	28/09/13	Date	28/09/13
Drawing Number	2250-004	Rev		Rev		Rev	A

SAFETY, HEALTH AND ENVIRONMENTAL INFORMATION

REGARDING TO THE DESIGN AND CONSTRUCTION OF THE WORKS, THE DESIGNER SHALL TAKE THE NECESSARY MEASURES TO ENSURE THAT THE WORKS ARE DESIGNED AND CONSTRUCTED IN A SAFE AND SOUND MANNER. THE DESIGNER SHALL ALSO TAKE THE NECESSARY MEASURES TO ENSURE THAT THE WORKS ARE DESIGNED AND CONSTRUCTED IN A MANNER THAT IS COMPATIBLE WITH THE ENVIRONMENT AND THE WELL-BEING OF THE COMMUNITY.

DATE: 28/09/13

NAME: _____

ROLE: _____

REVISIONS/DATE:

NO: _____

DATE: _____

NAME: _____

This page is intentionally left blank